

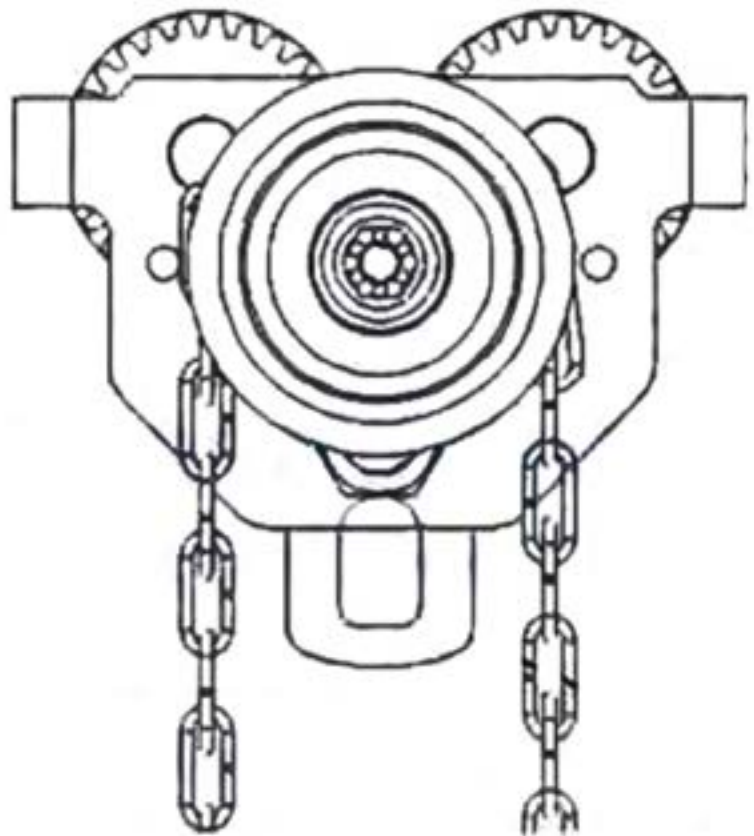

## PT. GT Series

---

User's Manual / Manual de usuario  
Safety Warnings / Advertencias de seguridad



**This page intentionally left blank**

PROPERTY REGISTRY N° 189487  
ANY REPRODUCTION IS FORBIDDEN  
PROPERTY OF PROWINCH® 2018 - V8.0 ALL RIGHTS RESERVED  
PROWINCH LLC COMPANY WITH QUALITY MANAGEMENT SYSTEM

## PROWINCH® DISCLAIMER

---

Prowinch® LLC declares that it has made available to the Customer each and every one of the security warnings related to the purchased product and that, as a result, it does not assume any responsibility for any damages or losses that may be suffered by the client or third parties. Cause or as a direct or indirect consequence of the breach or omission of any of the instructions or safety warnings contained in the User Manual and Security Warnings corresponding to the unit purchased.

In this sense, Prowinch® LLC will not be liable for accidents and / or damages to persons and / or property resulting from the negligent use of the product.

In no case does Prowinch® LLC assume any liability arising from the use of these voluntary recommendations, and does not offer any guarantee in relation to them. These recommendations do not take precedence over the current safety regulations of the plant.

For purposes of enforcing the Warranty of the product purchased, Prowinch® LLC, will only be liable for any damage when it is possible to prove that the user has followed each and every one of the warnings contained in the User Manual and Safety Warnings.

1. It is the sole responsibility of the Client / User to verify that the acquired equipment, products and accessories comply with the characteristics, capacities, requirements, components, accessories and other conditions for the use that the Client / user intends to give it.
2. It is also the sole responsibility of the Client / User to ensure that the equipment and products purchased are operated and maintained with adequate safety standards and by personnel duly trained in the use thereof. The Client / User is also responsible for implementing all the security measures necessary to prevent accidents or damages to people or property and for following the indications and warnings of the corresponding manual.
3. Any assistance provided by Prowinch® LLC in the selection of the equipment, the capacities and characteristics required by the clients is delivered free of charge and based on the information about the application, use and requirements indicated by the Client itself. It does not correspond to Prowinch® LLC to verify the accuracy of the given information. It is the sole and exclusive responsibility of the Client -or who will use the equipment and products acquired- to ensure that the specifications comply with the capabilities, characteristics, up-to-date maintenance and everything necessary for a correct and safe operation in relation to the intended use.
4. Prowinch® LLC recommends the use of winches with 4 brakes for personnel lifting. The use of winches of 3 brakes or less or safety features lower than the best available for personnel lifting, is the sole responsibility of the customer.
5. In order to guarantee the safety of the personnel and users of the equipment it is necessary to carry out the inspections and maintenance of the equipment according to the recommended frequency in relation to its work cycle. It is mandatory to keep record and evidence the written and photographic reports of: Maintenance, Start-up, Load Tests, Training, Certifications, Inspections and Reports of failures and accidents.
6. The aforementioned reports must be sent by email to [registros@prowinch.com](mailto:registros@prowinch.com) within the first 7 calendar days after the occurrence of an event.
7. Compliance with the timely implementation of the mandatory activities described in points 6 and 7 in addition to all the activities mentioned in the corresponding rules applied are the sole responsibility of the user. Failure to comply with the foregoing conditions releases Prowinch® LLC from any type of Liability and Warranty to the team, customer, staff or user, or any other liability that could be attributed to Prowinch® LLC.

The information contained in this manual may contain technical errors or inaccuracies. Prowinch® LLC is not responsible for typing errors, omission or incorrect information.

This manual is subject to change without prior notice. Download the latest version available at [www.prowinch.com](http://www.prowinch.com).

Always check [www.prowinch.com](http://www.prowinch.com) for the latest information regarding this product.



## WARNING

Hoists, Cranes and other Lifting and material-movement related equipment USERS, must be knowledgeable about the safe and proper use of this equipment and be aware of their responsibilities as outlined in all applicable standards and regulations.

The ASME/ANSI B30 Standard contains provisions that apply to the construction, installation, operation, inspection, testing, maintenance, and use of cranes and other lifting and material-movement related equipment.

As OSHA's, ASME and ANSI standards state, the installation, setup and operation of these units and equipment shall be performed by a qualified person.

OSHA requires rated load tests for new and altered cranes, OSHA's standard at 29 CFR 1910.179(k) states:

Operational tests.

Prior to initial use all new and altered cranes shall be tested to insure compliance with this section including the following functions:

Hoisting and lowering.

Trolley travel.

Bridge travel.

Limit switches, locking and safety devices.

The trip setting of hoist limit switches shall be determined by tests with an empty hook traveling in increasing speeds up to the maximum speed. The actuating mechanism of the limit switch shall be located so that it will trip the switch, under all conditions, in sufficient time to prevent contact of the hook or hook block with any part of the trolley.

Rated load test. Test loads shall not be more than 125 percent of the rated load unless otherwise recommended by the manufacturer.

Once a rated load test is performed, paragraph 1910.179(k)(2) requires that "[t]he test reports shall be placed on file where readily available to appointed personnel."

In order to ensure Safety and installation requirements Prowinch requires Load Tests to be performed prior to initial use for all Hoists, Winches and Cranes, as well as other related components. Not fulfilling this requirement is dangerous, could lead to equipment failure and will automatically void the warranty.

The B30 Standard is intended to:

(a) Prevent or minimize injury to workers, and otherwise provide for the protection of life, limb, and property by prescribing safety requirements.

(b) Provide direction to manufacturers, owners, employers, users, and others concerned with, or responsible for, its application.



## WARNING

(c) Guide governments and other regulatory bodies in the development, promulgation, and enforcement of appropriate safety directives.

The equipment covered by the B30 Standard is subject to hazards that cannot be abated by mechanical means, but only by the exercise of intelligence, care, and common sense. It is therefore essential to have personnel involved in the use and operation of equipment who are competent, careful, physically and mentally qualified, and trained in the proper operation of the equipment and the handling of loads. Serious hazards include, but are not limited to, improper or inadequate maintenance, overloading, dropping or slipping of the load, obstructing the free passage of the load, and using equipment for a purpose for which it was not intended or designed.

Failure to Read, Understand and Follow the information in the corresponding ASME B30 Standard for your Hoist and Lifting equipment may result in severe INJURY or DEATH. It is YOUR RESPONSIBILITY to consider all risk factors and follow all the equipment related ASME B30 standard, which comprises the following volumes:

B30.1 Jacks, Industrial Rollers, Air Casters, and Hydraulic Gantries.

B30.2 Overhead and Gantry Cranes (Top Running Bridge, Single or Multiple Girder, Top Running Trolley Hoist).

B30.3 Tower Cranes.

B30.4 Portal and Pedestal Cranes.

B30.5 Mobile and Locomotive Cranes.

B30.6 Derricks.

B30.7 Winches.

B30.8 Floating Cranes and Floating Derricks.

B30.9 Slings.

B30.10 Hooks.

B30.11 Monorails and Underhung Cranes.

B30.12 Handling Loads Suspended From Rotorcraft.

B30.13 Storage/Retrieval (S/R) Machines and Associated Equipment.

B30.14 Side Boom Tractors.

B30.15 Mobile Hydraulic Cranes.

B30.16 Overhead Hoists (Underhung).

B30.17 Overhead and Gantry Cranes (Top Running Bridge, Single Girder, Underhung Hoist).

B30.18 Stacker Cranes (Top or Under Running Bridge, Multiple Girder With Top or Under Running Trolley Hoist).

B30.19 Cableways.

B30.20 Below-the-Hook Lifting Devices.

B30.21 Lever Hoists.

B30.22 Articulating Boom Cranes.

B30.23 Personnel Lifting Systems.

B30.24 Container Cranes.

B30.25 Scrap and Material Handlers.



## WARNING

B30.26 Rigging Hardware.  
B30.27 Material Placement Systems.  
B30.28 Balance Lifting Units.  
B30.29 Self-Erecting Tower Cranes.  
B30.30 Ropes.

## DO NOT



## WARNING

1. DO NOT Operate, install, or repair the hoist unless trained and authorized.
2. DO NOT Operate the hoist unless you have first read the operator's manual.
3. DO NOT Operate the hoist without appropriate PPE and without performing a pre-shift inspection.
4. DO NOT Operate the hoist if not complying with all required OSHA regulations.
5. DO NOT Lift more than the rated load.
6. DO NOT Lift people or lift loads over people.
7. DO NOT Wrap the hoisting rope or chain around the load.
8. DO NOT Operate with the chain/rope not properly seated in the sprockets, drum, or sheave.
9. DO NOT Operate unless the direction of the hook travel agrees with the direction shown on the control.
10. DO NOT Operate the hoist unless the hook travel limit devices function properly. (Test without a load PRE-SHIFT )
11. DO NOT Operate the hoist with twisted, kinked, damaged, dirty, or unlubricated chain or rope.
12. DO NOT Operate a damaged or malfunctioning hoist.
13. DO NOT Operate the hoist when the hook is not centered under the hoist
14. DO NOT Remove or obscure this tag or other WARNING & SAFETY LABELS.

## DAILY CHECKLIST



## WARNING

TAGGED HOIST: Ensure the crane or hoist is not tagged out of order.

CONTROL DEVICES: Test Run. Ensure all motions agree with control device marking.

BRAKES: Check all motions for excessive drift and abnormal stopping distances.

HOOK: Check for damage, cracks, nicks, gouges, deformations on throat opening, wear on saddle or load-bearing point, and twist.

HOOK LATCH: Check for proper operations.



## WARNING

**WIRE ROPE:** Check for broken wires, broken strands, kinks, and deformation or damage to the rope structure.

**CHAIN:** Check for corrosion, wear, elongation, twist, nicks, or gouges. Keep Chain/Wire Rope Clean and Lubricated.

**REEVING:** Check the rope for proper reeving and that rope parts are not twisted.

**LIMIT SWITCHES:** Ensure that all limit devices stop lifting motion before the load block or chain/rope stop strikes the hoist.

**OIL LEAKAGE:** Check for any signs of oil leakage on the crane/hoist and the floor.

**UNUSUAL SOUNDS:** Check for unusual sounds from the hoist while operating.

**WARNING & SAFETY LABELS:** Ensure that labels are not missing and they are legible.

---

<b>DISCLAIMER .....</b>	<b>3</b>
<b>SAFETY BULLETIN.....</b>	<b>4</b>
<b>SAFETY PRECAUTIONS .....</b>	<b>9</b>
Crane Safety Precautions .....	10
Before Using the equipment .....	10
During Operation .....	11
Inspection, Maintenance and repairs .....	11
<b>SPECIFICATIONS .....</b>	<b>12</b>
Plain Trolley .....	12
Geared Trolley .....	12
<b>INTRODUCTION.....</b>	<b>13</b>
General information .....	13
Safety codes .....	13
Warranty .....	13
<b>INSTALLATION.....</b>	<b>14</b>
Safety notes .....	14
Installation instructions .....	14
<b>OPERATION .....</b>	<b>15</b>
Operation .....	15
Safety notes .....	15
Handings the load .....	15
Inspection/Maintenance .....	16
<b>TECHNICAL INFORMATION.....</b>	<b>17</b>
Technical information .....	17
<b>OPERATIONAL INSTRUCTION.....</b>	<b>18</b>
Operational instruction .....	18



Thank you for purchasing our Prowinch® Electric Crane. This User Manual provides important information for personnel involved with the installation, operation, and maintenance of this product. Read this User Manual before installing, operating, or maintaining the product.

## 1. SAFETY PRECAUTIONS

The Prowinch® Electric Crane is designed for a safe and reliable service if operated according to the User Manual. Respect and follow all warnings for personnel and third party safety indications. Inadequate operation may cause serious risks of injuries to personnel or damage to the equipment. Read and understand this User Manual carefully before installing and commissioning the equipment. Always keep this User Manual in an accessible place for future reference. The compact and lightweight structure of the PWPHP models together with their ease of use makes them a preferred cranes for daily use in factories, mines, sea ports and warehouses.

Improperly installed, maintained, or operated cranes can be the cause of serious accidents or death. This User Manual highlights symbols and notes for caution, warning and danger. Following these indications greatly improves the safety of the operator and personnel in the area.

### Mandatory use of:



**Hard Hat**



**Safety Glasses**



**Safety Gloves**



**Safety Shoes**

## 1.1. Crane Safety Precautions



**WARNING:**

This symbol indicates unsafe practices or situations which may cause damage to the property and even injuries to the personnel.



**DANGER:**

This symbol indicates a potentially dangerous situation which if not avoided may cause severe injuries or death



**DANGER**

All operators and other users who are near the steel wire rope or its load must wear required safety equipment: gloves, safety helmet / hard hat, safety shoes and eye protection.



**WARNING**

Before installing, removing, inspecting, or performing any maintenance on the crane, the unit must be unplugged, locked out, and tagged out.  
Do not use this equipment in hazardous locations.

Read and understand the contents of this User Manual thoroughly before handling the electric crane. Practicing correct and safe operating procedures and carrying out the recommended preventative maintenance will ensure a long, reliable, and safe service.

After carefully reading and understanding the User Manual, store it for future reference.

## 1.2. Before using the Equipment:

- Read and understand the instructions in this User Manual and all the labels associated with the crane before operating the equipment.
- Wear appropriate clothing: Do not wear jewelry or loose clothes as they can get caught by the wire rope or hook.
- Wear leather gloves.
- Wear non-slip safety shoes, hard hat, and eye protection.
- Perform a full check of the crane. Check for damaged parts or unusual conditions.
- Keep a safe distance: suggested distance is at least 1.5 times the length of the wire rope. A broken or loose wire rope may cause injuries or death.
- Check that the crane and wire rope are properly lubricated.
- Secure the electric crane to a suitable base.
- Visually inspect all electric Cranes before each use in addition to the regular inspections and maintenance.

### 1.3. During Operation:

#### ALWAYS:

- Refer to the maximum load capacity displayed on the ID plate attached to the crane, not the capacity of the hook.
- Stop operation immediately if unauthorized personnel enter the working area.
- Check the working condition of the crane: If the motor gets too hot stop the crane and let it cool down for a while.
- Stop, check, and secure the load if the crane stops or loses movement during operation.
- Focus on the operation. Pay attention at all times and keep proper balance.
- Unplug the crane after operation.

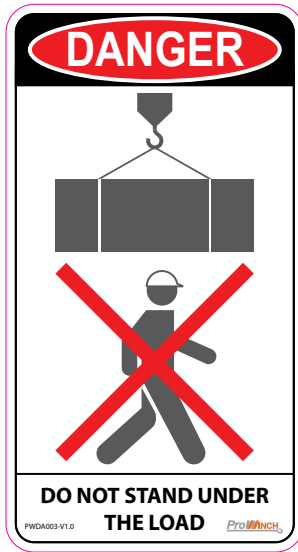

#### NEVER:

- **Never** exceed the maximum load capacity of the crane.
- **Never** operate a damaged or malfunctioning crane.
- **Never** operate the crane if it shows an abnormal behavior.
- **Never** lift, support, or transport people or loads over people.
- **Never** walk or step on the wire rope.
- **Never** operate the electric crane with twisted, kinked, damaged or worn wire rope.
- **Never** use the wire rope as a sling around load.
- **Never** operate a crane if the ID plate or safety labels are missing or illegible.
- **Never** operate an electric crane if exposed to rain or water.
- **Never** use if operator is sick or not completely attentive.
- **Never** leave the crane unattended while energized or loaded.
- **Never** operate the crane with non-centered load.
- **Never** operate beyond the limits of the wire rope or extend the cable.
- **Never** use the wire rope or hook as an electrical or welding ground.
- **Never** remove the labels placed on the electric crane.
- **Never** use the crane to lift load at an angle, nor pull or drag

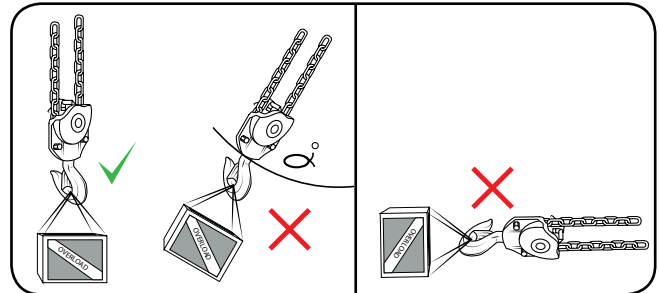

### 1.4. Inspection, Maintenance and Repairs:

- Only trained and authorized personnel may perform repairs to the equipment.
- Use only original ProWinch® parts. The use of any other part immediately voids the warranty.
- Failure to use only original ProWinch® parts may create a dangerous condition for the operator.

#### ALWAYS:

- Check the condition of electrical connections.
- Check the wire rope and keep it lubricated.
- Prevent others from stepping under lifted load.
- Inspect and maintain the crane regularly.
- Verify the correct installation of the crane before using.
- Avoid contact with explosive gases or materials.

#### NEVER:

- **Never** overload the crane.
- **Never** transport people or animals with the crane.
- **Never** stand under suspended load.
- **Never** use the crane if exposed to rain, snow, or lightning
- **Never** leave loads suspended for an extended period of time. This may cause component deformation and accidents.
- **Never** exceed the allowable operating temperatures stated in this User Manual (differs depending on the model).
- **Never** expose the crane to water, sand, corrosive materials or other substances which may damage the equipment.

## 2. SPECIFICATIONS

### 2.1. PLAIN TROLLEY.

**PLAIN TROLLEY PT SERIES SPECIFICATION**

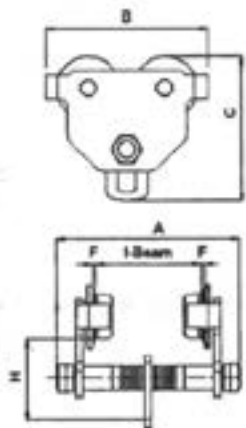

Capacity	I-Beam Width	Amm	Bmm	Cmm	Hmm	N.W./KGS
0.5T	68~140 mm	220	196	177	97	4.8
1T	80~146 mm	230	213	191	107	7
2T	80~168 mm	275	255	233	128	13
3T	88~168 mm	285	300	285	153	20.2
5T	100~203 mm	368	340	345	191	34
10T	122~203 mm	375	454	477	262	79

### 2.2. GEARED TROLLEY

**GEARED TROLLEY GT SERIES SPECIFICATION**

Notes: the standard hand Pulley Chain is 3 meters.

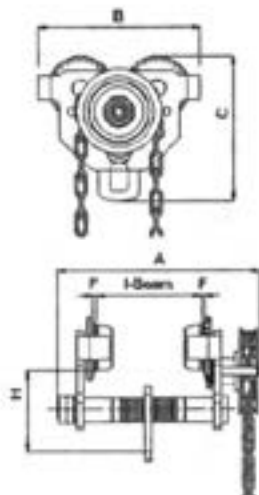

Capacity	I-Beam Width	Amm	Bmm	Cmm	Hmm	N.W./KGS
0.5T	68~140 mm	262	196	177	97	7.9
1T	80~146 mm	266	213	191	107	12.5
2T	80~168 mm	312	255	233	128	17.9
3T	88~168 mm	324	300	285	153	28.4
5T	100~203 mm	401	340	345	191	42.1
10T	122~203 mm	412	454	477	262	82

### 3. INTRODUCTION

---

#### 3.1. GENERAL INFORMATION

This manual provides information for the installation & maintenance of PT.GT series Manual Trolleys Normally furnished with industrial hand hoist/electric chain hoists.

#### 3.2. SAFETY CODES

Refer to Hoists Operating & Maintenance Instructions for guidelines and applicable standards for safe trolley and hoists operation.

#### 3.3. WARRANTY

Every trolley is thoroughly inspected and tested prior to shipment. This warranty does not apply where deterioration is caused by normal wear, abused, eccentric or side loading, overloading.

## 4. INSTALLATION

---

### 4.1. SAFETY NOTES

Inspect trolley for any evidence of shipping damage or loose parts. Be sure that beam end stops are in place.

Hand trolley was designed to travel on a beam and carry a load up to its rated capacity. The capacity indicated on the trolley (see nameplate) is the maximum safe working load which must not be exceeded.

### 4.2. INSTALLATION INSTRUCTIONS

All model, to 20000kg PT.GT type. Measure the flange width of the beam, Evenly distribute the two spacer sleeves and spacer washers on both sides of the load bar equal to the beam flange width plus 4mm. The clearance between the trolley wheel flange and the beam edge must be 2mm on each side when finally assembled. Secure both side plate and tighten both hex nuts tightly. Check operation of the trolley by rolling it along it along the beam with load. Make sure the trolley is properly adjusted to the beam, each wheel rolls freely and makes good contact with the flange of the beam and the side plates are parallel.

## 5. OPERATION

---

This section offers guidelines for the proper operation of the trolley with hand of electric hoists. It is not intended to serve as a rigging hand book.

### 5.1. SAFETY NOTES

Inspect trolley for any sign of loose, broken or malfunction parts, Any malfunction trolley should be tagged as "out of order" Before operation, operator should be certain that all personnel are clear.

Do not carry more than the rated load of the trolley.

Do not leave a suspended load unattended.

The operator should have a clear view of the load anytime it is moving and should be sure that the load does not contact obstructions.

Apart from the operating instructions and Safety Act of each respective country. General accepted regulations for safe and professional work must be adhered to.

### 5.1. HANDING THE LOAD



#### WARNING

New operator has to be trained prior to use

Along trolley hoist directly over the load. Avoid side pull or any action which causes trolley wheels to lift off one side of beam.

Bring the hoist hook into engagement with the load and make sure it is well seated before proceeding to move the load.

Proceed to lift the load to the height necessary to clear any objects over which the load must pass.

Avoid letting load swing excessively while moving the trolley.

Let the trolley coast to a stop instead.

Do not run the trolley into beam end stops of other trolleys on the beam.

## 6. INSPECTION / MAINTENANCE

The trolley should be inspected for damage, loose parts and excessive wheel wear at the same time as hoist inspection.



7. TECHNICAL INFORMATION

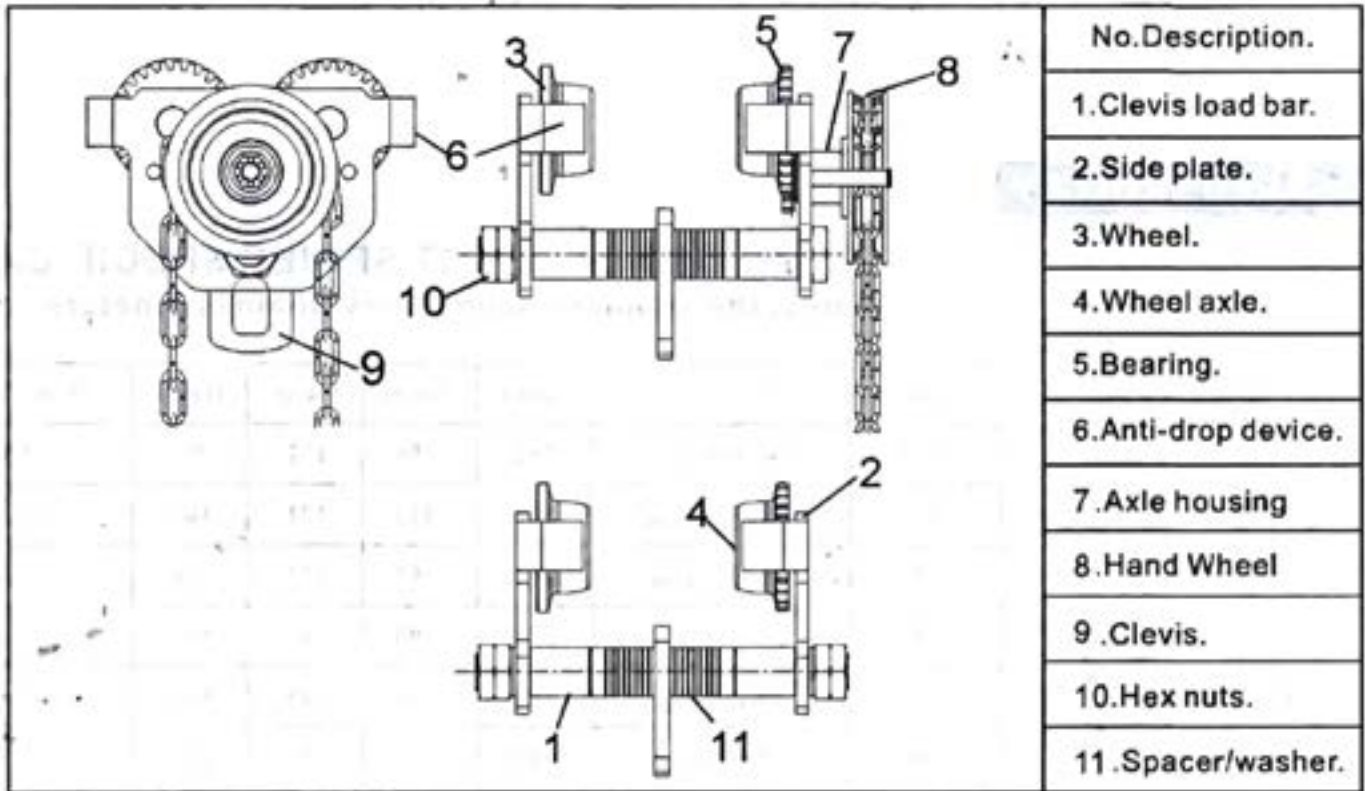

## 8. OPERATIONAL INSTRUCTION

---

- Measure the actual width of the runway beam.
- Assemble the required number of spacer washers equally to the inside of the trolley side plates so that the dimension between Trolley Wheel Flanges is 6mm of 1/4 (Max) greater than the Runway Beam width. Assemble the remaining washers outside the Trolley
- Side plate & fit Nuts to Hanger Pin. THERE MUST ALWAYS BE AT LEAST ONE WASHER ON THE INSIDE - THE OUTSIDE OF EACH TROLLEY SIDE PLATE (see diagram N).  
Slacken off the Hanger Pin Nuts & spread the side plates so that the wheels can be slip peer up over the Runway Beam. Screw the Nuts firmly against the Washers, then suspend a light load from the trolley to ensure that all four Wheels contact the Runway Beam. Screw the Nuts tightly against the Washers then secure with lockouts.



### WARNING

New operator has to be trained prior to use



**Prowinch LLC**

**[www.prowinch.com](http://www.prowinch.com)**

2545 NW 74th Ave Miami, Florida, 33122

United States

+1 (800) 971-8061

**Equipos de Izaje Prowinch Chile Spa**

**[www.prowinch.cl](http://www.prowinch.cl)**

Parque Riesco 3407, Recoleta,

Región Metropolitana, Chile

+56-2-26218989

**Fortis Alloy Mexico S.A. de C.V**

**[www.prowinch.mx](http://www.prowinch.mx)**

Fortis Alloy Mexico, S.A. de C.V. Vicente Guerrero No. 403

Col. San Miguel, Apodaca, Nuevo Leon,

Mexico C.P. 66649

+52 (81) 8244-1351

**Prowinch Colombia SAS**

**[www.prowinch.co](http://www.prowinch.co)**

Cl. 163a #20-28, Bogotá, Colombia

+57 1 7034035

**Provedora Industrial y Tecnica, S.A. de C.V.**

**[www.prointe.com.sv](http://www.prointe.com.sv)**

Av. Alberto Masferrer Sur, Col. Campestre No. 211

San Salvador, El Salvador

2264-1100

**Representaciones Ivankovich RA S.A.**

**[ivankovich.co.cr](http://ivankovich.co.cr)**

100 mt. Este y 300 Mt. Sur de las Oficinas Centrales del

INS, Cartago, Costa Rica

(506) 2553-1415